

IMPORTANT LYNX UPDATE INFORMATION

Further user enhancements have been made to the LYNX Module and Operator Interface to improve your overall product experience. These upgrades provide additional features, enhancements, and clarity to the LYNX system.

The following pages offer step-by-step instructions to update your LYNX Module (Versions 3 or 4) and LYNX Operator Interface Firmware. **Please make every effort to upgrade your hardware and/or firmware as soon as possible to ensure optimal performance of your LYNX system.**

LYNX Module, Hardware Version 3, Firmware Version 1.10

- ▶ Updated display for values larger than 999 (HXX)
- ▶ Fast scroll has extra level of speed for large edits
- ▶ Ramp rate has increased stability
- ▶ Increased EMC stability during enumeration
- ▶ More informative startup display for troubleshooting
- ▶ Improved stability of raw temperature measurements
- ▶ Ability to enable or disable heater break
- ▶ Increased stability to ambient issues

LYNX Module, Hardware Version 4, Firmware Version 1.1

- ▶ **Includes all changes to Hardware Version 3**
- ▶ New Update Method which is more robust
- ▶ Scrolling for Menus, Alarms, and Temperatures above 999

LYNX OI, Firmware Version 1.5

- ▶ **Required to support LYNX Modules:**
Hardware Version 4
- ▶ Sensor faults display “N/A” in temperature area
- ▶ Graph cleaned during periods of disconnection
- ▶ Added forward compatibility to future module versions
- ▶ New hardware update options



Installing LYNX Module and Operator Interface Software Updates

Updating LYNX Operator Interface (OI) Firmware

Step 1:

Download the latest version of the Operator Interface firmware from: briskheat.com/lynx-updates. Save the update software to a USB drive.

Step 2:

Insert the USB drive into the side port of the Operator Interface Panel. The Panel will prompt the user with a confirmation that a USB Device has been connected. Select “Okay” to proceed with the connection.

Step 3:

Proceed to the **About** screen. This is under the **Operator Interface Settings** menu option in the **System Menu**.

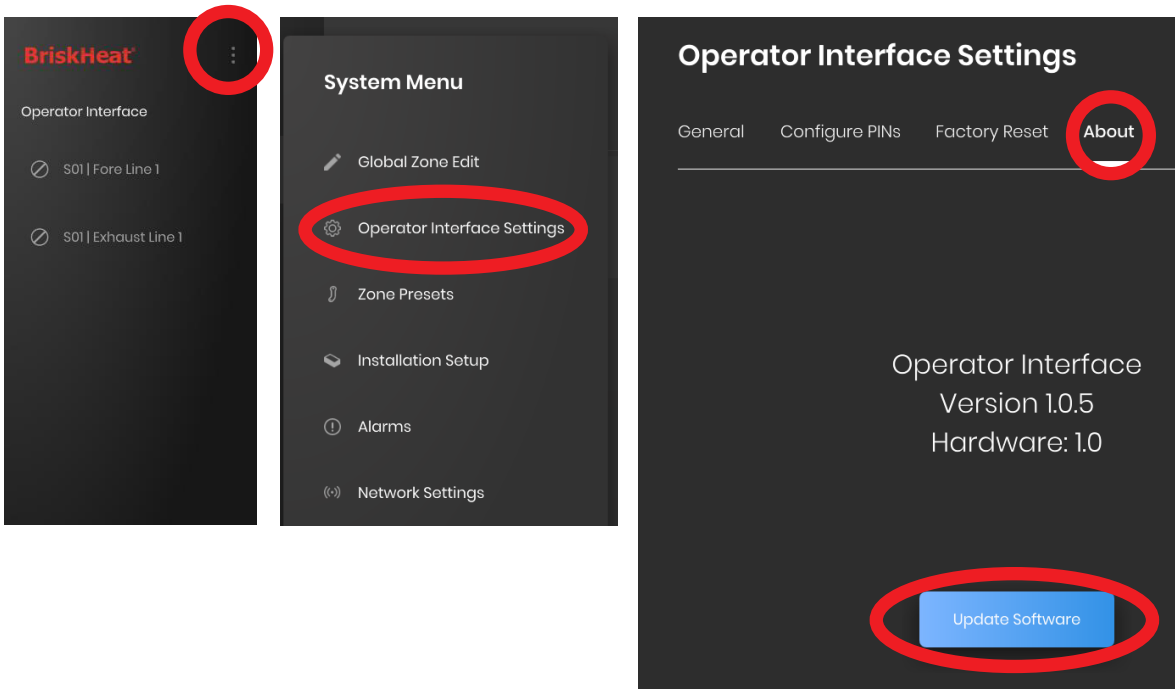

Step 4:

Select **Update Software** and select the update file downloaded in step 1. Select **Update Software** to begin the Update process. Do not shutdown or unplug the OI or disconnect the USB during this process. Once the operation is complete, the system will restart and apply the update.

BriskHeat®

Installing LYNX Module and Operator Interface Software Updates

Updating LYNX Module Firmware

NOTE: ENSURE THE OPERATOR INTERFACE IS UPDATED OR THE MODULE UPDATE FILE MAY NOT BE RECOGNIZED

Step 1:

Download the latest version of the module firmware from: briskheat.com/lynx-updates. Save the update software to a USB drive.

Step 2:

Insert the USB drive into the side port of the Operator Interface Panel. The Panel will prompt the user with a confirmation that a USB Device has been connected. Select “Okay” to proceed with the connection.

Step 3:

Proceed to the **Firmware Update** screen. This is under the **Global Zone Edit** menu option in the System Menu

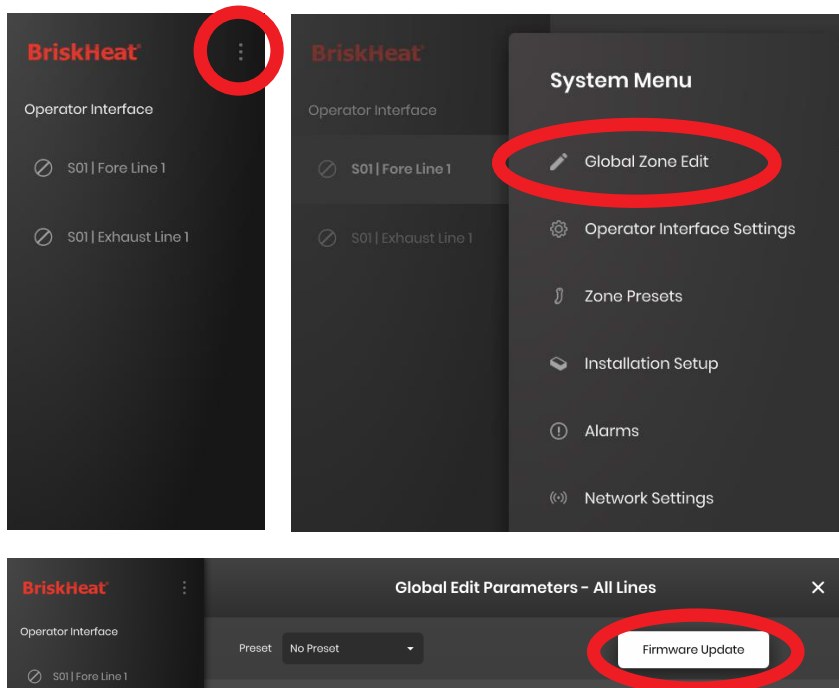

Step 4:

Select **Firmware Update** and select the firmware file downloaded in step 1 to use in the update. Select **Update Firmware** to begin the Update process. Datalogging will be suspended and modules may flash while the Modules are updating. The modules will restart after the update is complete, and once complete, you are free to close the screen.

BriskHeat®